

REV. NO.		REV. DATE	DESCRIPTION	BY	CHK	APP
00	1					
00	2					
00	3					

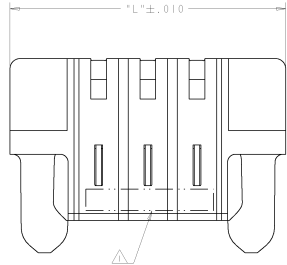

- △ "AMP", PART NUMBER AND DATE CODE TO BE MARKED IN AREA SHOWN. PARTS UNDER 2.000 MAY BE MARKED ON BOTH SIDES.
- △ MATERIAL: HOUSING - GLASS FILLED HIGH TEMP THERMO PLASTIC, UL94 V-0. POWER CONTACT - HIGH CONDUCTIVITY COPPER ALLOY
- △ CONTACT PLATING: POWER CONTACTS - .000050 MIN Ni UNDER ALL .000030 MIN Au ON CONTACT AREA. .000100 MIN Sn AT PCB INTERFACE.
- △ MECHANICAL CONNECTOR KEEP OUT ZONE.
- △ DATUM AND BASIC DIMENSIONS ESTABLISHED BY CUSTOMER.
- △ PCB - ALL HOLE DIAMETERS ARE FINISHED HOLE SIZES.
- △ PCB - .0453 +/- .0010 DRILLED HOLES PLATES WITH .0003 MIN Sn OVER .001 TO .003 PLATING TO ACHIEVE A .040 DIA. HOLE.

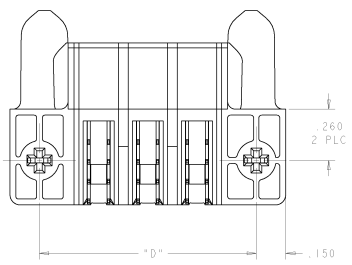
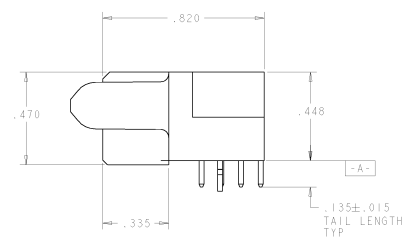
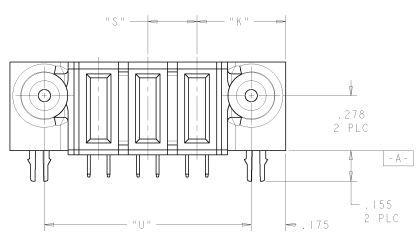

INCHES	MILLIMETERS	INCHES	MILLIMETERS	INCHES	MILLIMETERS	INCHES	MILLIMETERS
.250	2.300	2.350	2.650	.450	.850	.850	8.450
.250	1.050	1.100	1.400	.450	.850	.850	8.450

"S"	"U"	"D"	"L"	"K"	DESCRIPTION	PART NUMBER
					RIGHT ANGLE RECEPTACLE ASSEMBLY WITH GUIDES MULTI-BEAM XL	6450163-2

AMP Teledyne Electronics
 Harrisburg, PA 17105-8808

RIGHT ANGLE RECEPTACLE ASSEMBLY WITH GUIDES MULTI-BEAM XL

DATE: 00778 (C) 6450163

CUSTOMER DRAWING: [blank]

REV	DATE	DESCRIPTION	BY	CHKD	APPD
00		SEE SHEET 1			

PART NUMBER	ROWS	POWER		
		P3	P2	P1
6450163-1	D C B A	RA	RA	RA
3P				

PART NUMBER	ROWS	POWER							
		P8	P7	P6	P5	P4	P3	P2	P1
6450163-2	D C B A	RA	RA	RA	RA	RA	RA	RA	RA
8P									

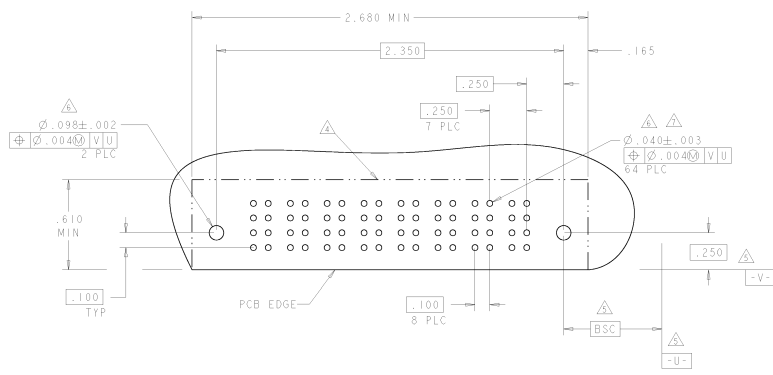
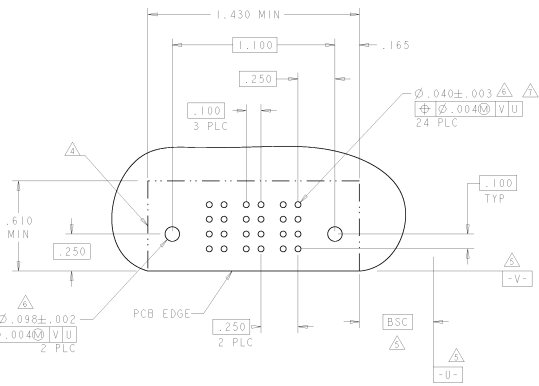

RM	.135	STD
RA	.135	MFBL
CODE	TAIL LENGTH	TYPE
POWER CONTACT		

DRAWING INFORMATION		MATERIAL		FINISH		TOLERANCES UNLESS OTHERWISE SPECIFIED		DIMENSIONS UNLESS OTHERWISE SPECIFIED		DRAWING NUMBER	
INCHES	FRAMES	STAINLESS STEEL	BRASS	PLATED	PLATED	DECIMALS	FRACTIONS	INCHES	MILLIMETERS	6450163-1	6450163-2