

REV	DATE	DESCRIPTION	BY	CHK	APP
00					
B3		REVISE DASH NUMBER -11	SHUPPERS	OL	SF
B4		ADD HOLD DOWNS FOR -11	SHUPPERS	OL	SF
B5		REV PER ECR-10-00079	SHUPPERS	OL	SF
B6		REV PER ECR-10-01286	SHUPPERS	AL	SF

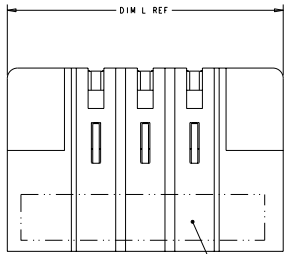

- △ "AMP", PART NUMBER, AND DATE CODE TO BE MARKED IN AREA SHOWN.
- △ MATERIAL: HOUSING - GLASS FILLED HIGH TEMP THERMO PLASTIC. UL94 V-0
POWER CONTACT - HIGH CONDUCTIVITY COPPER ALLOY
- △ CONTACT PLATING: POWER CONTACTS - .000050 MIN. NI UNDER ALL.
.000030 MIN. Au AT CONTACT AREA.
.000100 MIN. Sn AT PCB INTERFACE.
- △ MECHANICAL CONNECTOR KEEP OUT ZONE.
- △ DATUM AND BASIC DIMENSIONS ESTABLISHED BY CUSTOMER.
- △ PCB - ALL HOLE DIAMETERS ARE FINISHED HOLE SIZES.
- △ PCB - .0453±.0010 DRILLED HOLES WITH .0003 MIN Sn OVER
.001 TO .003 Cu PLATING TO ACHIEVE A .046±.003 DIA HOLE.
- △ VARIABLE DIMENSIONS SHOWN ON VIEW (SHEET 3)
- △ FOR DETAIL DIMENSION PLEASE REFER TO TABLE

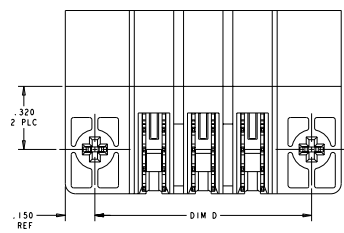
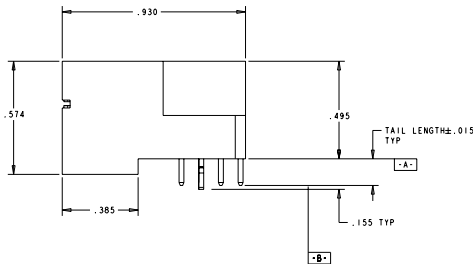
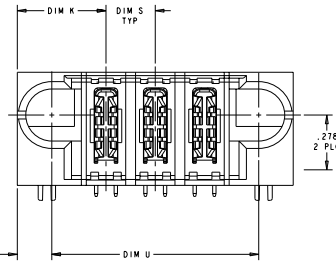

2.700	.300	2.750	.475	3.050	8ACP	1-6450123-4
1.300	.200	1.350	.425	1.650	5HDP	1-6450123-2
5.550	.200	5.600	.450	5.900	26P	1-6450123-1
1.700	.200	1.750	.425	2.050	7HDP	1-6450123-0
2.300	.250	2.350	.450	2.650	8P	6450123-8
1.700	△	1.750	.425	2.050	6P	6450123-7
1.550	.250	1.600	.450	1.900	5P	6450123-6
2.050	.250	2.100	.450	2.400	7P	6450123-5
.800	.250	.850	.450	1.150	2P	6450123-4
1.200	.300	1.250	.475	1.550	3ACP	6450123-3
1.300	.250	1.350	.450	1.650	4P	6450123-2
1.050	.250	1.100	.450	1.400	3P	6450123-1
DIM U	DIM S	DIM D	DIM K	DIM L	DESCRIPTION	PART NUMBER

DIMENSIONS IN MILLIMETERS UNLESS OTHERWISE SPECIFIED INCHES		TECH ELECTRONICS CORPORATION 100-1913 116-13038 00779		TECH ELECTRONICS CORPORATION 100-1913 116-13038 00779		Tech Electronics Harrisburg, PA 17105-3600	
CUSTOMER DRAWING		CUSTOMER DRAWING		RIGHT ANGLE HEADER ASSEMBLY W/GUIDES MULTI-BEAM XL		STATE CASE CODE DRAWING NO A 00779 ©-6450123	
SHEET 2 OF 2		DRAWING NO. 00779		PART NO. 6450123		DATE 11/16/06	

DATE: 10/14/2016
 DESIGNED BY: J. BIRNBAUM
 CHECKED BY: J. BIRNBAUM
 APPROVED BY: J. BIRNBAUM
 TITLE: 6450123-1
 BY: TERRY ELECTRONICS CORPORATION. ALL RIGHTS RESERVED.

REV	DATE	DESCRIPTION	BY	CHK
00		SEE SHEET 1		

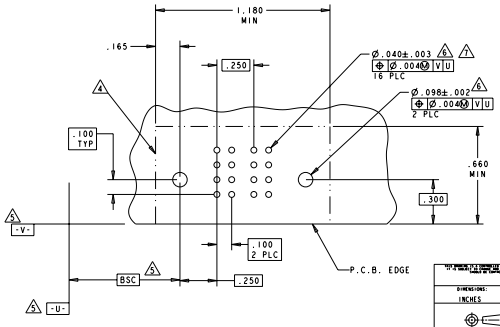
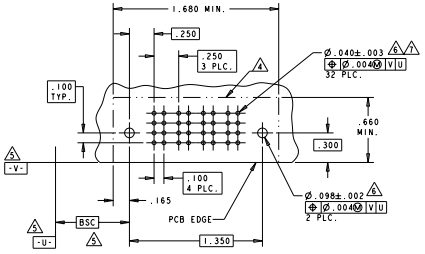
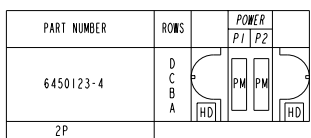
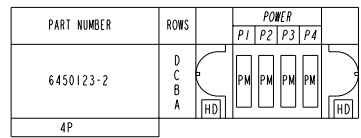
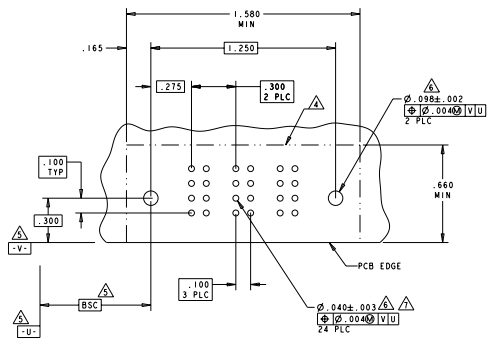
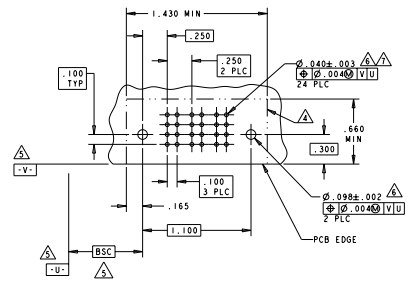
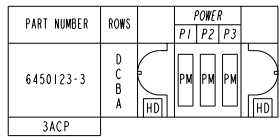
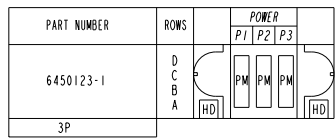

PA	.090
PM	.135
CODE	TAIL LENGTH
POWER CONTACT	

TERRY ELECTRONICS CORPORATION 116-13038 HARRISBURG, PA 17105-3600		TERRY ELECTRONICS CORPORATION 116-13038 HARRISBURG, PA 17105-3600	
PART NUMBER: 6450123-1 INCHES: 116-13038 TITLE: RIGHT ANGLE HEADER ASSEMBLY W/GUIDES MULTI-BEAM XL DATE: 10/14/2016 DRAWN BY: J. BIRNBAUM CHECKED BY: J. BIRNBAUM APPROVED BY: J. BIRNBAUM	PART NUMBER: 6450123-1 INCHES: 116-13038 TITLE: RIGHT ANGLE HEADER ASSEMBLY W/GUIDES MULTI-BEAM XL DATE: 10/14/2016 DRAWN BY: J. BIRNBAUM CHECKED BY: J. BIRNBAUM APPROVED BY: J. BIRNBAUM	PART NUMBER: 6450123-1 INCHES: 116-13038 TITLE: RIGHT ANGLE HEADER ASSEMBLY W/GUIDES MULTI-BEAM XL DATE: 10/14/2016 DRAWN BY: J. BIRNBAUM CHECKED BY: J. BIRNBAUM APPROVED BY: J. BIRNBAUM	PART NUMBER: 6450123-1 INCHES: 116-13038 TITLE: RIGHT ANGLE HEADER ASSEMBLY W/GUIDES MULTI-BEAM XL DATE: 10/14/2016 DRAWN BY: J. BIRNBAUM CHECKED BY: J. BIRNBAUM APPROVED BY: J. BIRNBAUM

REV	DESCRIPTION	DATE	BY
00	SEE SHEET 1		

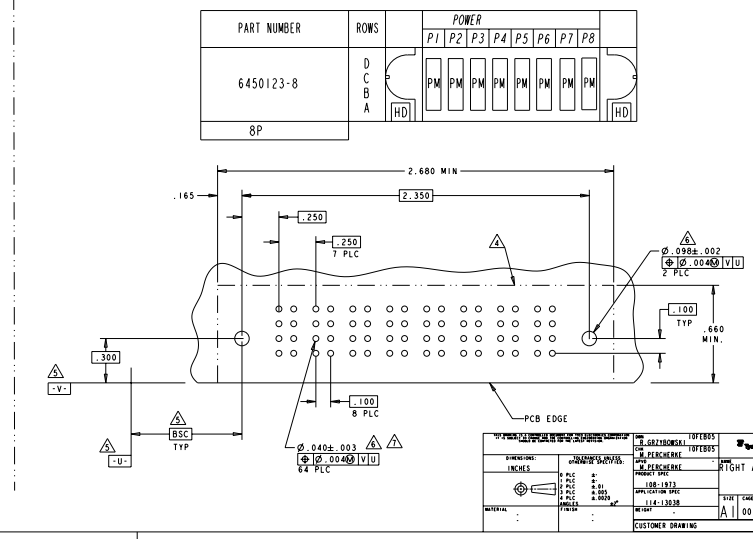
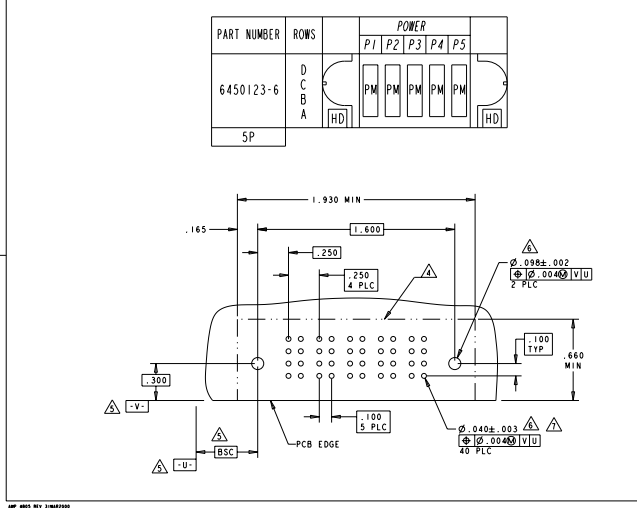
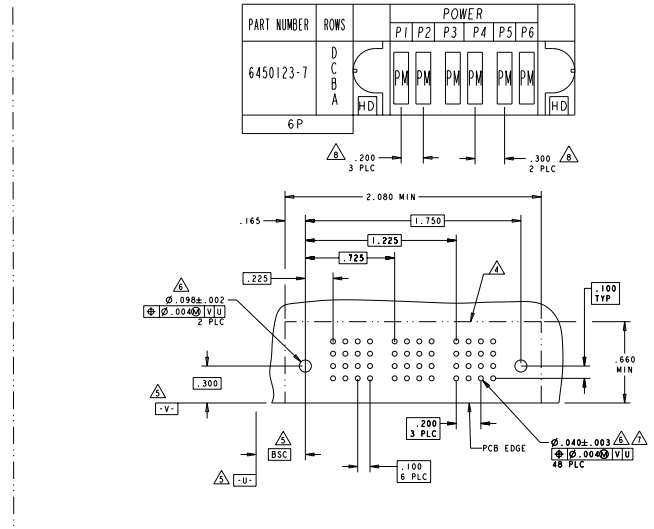
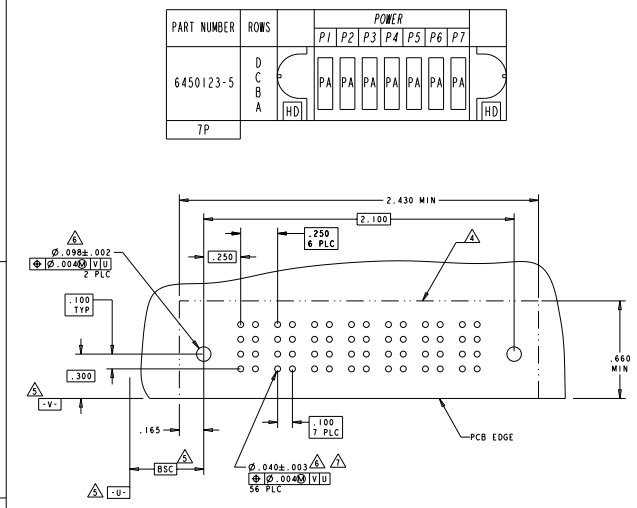

DATE: 08/24/2018	BY: PCB ELECTRONICS CORPORATION	REV: 00	DESCRIPTION: SEE SHEET 1	DATE: 08/24/2018	BY: PCB ELECTRONICS CORPORATION
PCB ELECTRONICS CORPORATION 1000 W. MARKET STREET, SUITE 100 PHILADELPHIA, PA 19103-3600 TEL: 215-381-1338 FAX: 215-381-1339 WWW.PCB-ET.COM		TOPOFFERS W. FLECHNER 100-1313 116-13038 00778 ©-6450123		Title: RIGHT ANGLE HEADER ASSEMBLY W/GUIDES Multi-Beam XL SHEET 1 OF 3 3 OF 6	

REV	DATE	DESCRIPTION	BY	CHK	APP
GP	00	SEE SHEET 1			

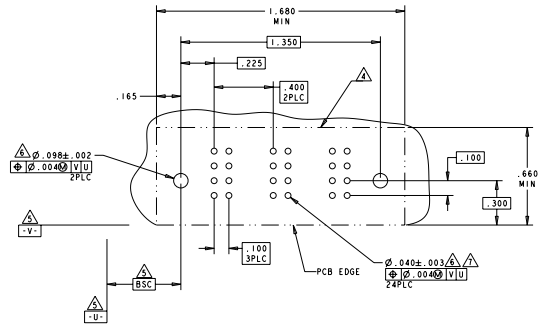
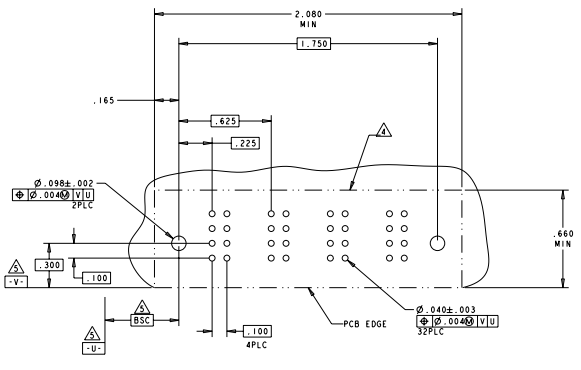
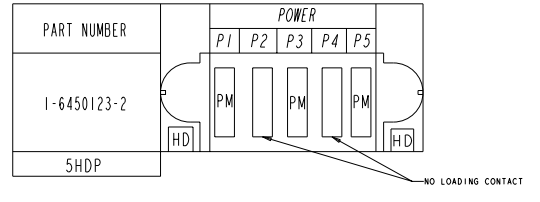
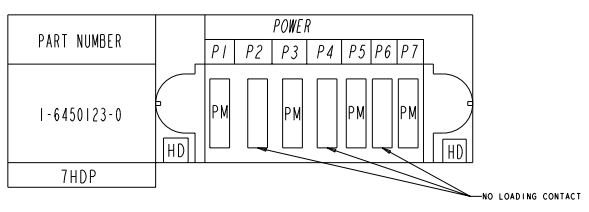

TITLE: CUSTOMER DRAWING INCHES DATE: 03/20/2022 DRAWN BY: J. J. J. CHECKED BY: J. J. J. APPROVED BY: J. J. J.	CUSTOMER: 00778 PART: 1-6450123-0 REV: A DATE: 03/20/2022	ORDER NO: 100-1933 QUANTITY: 114-13038 ORDER NO: 100-1933	TECH ELECTRONICS CORPORATION 100-1933 114-13038 00778 ©-6450123 CUSTOMER DRAWING	TITLE: RIGHT ANGLE HEADER ASSEMBLY W/GUIDES MULTI-BEAM XL SCALE: 1:1 SHEET: 4 OF 6 DATE: 03/20/2022
--	--	---	--	--

REV	DATE	DESCRIPTION	BY	CHK
00		SEE SHEET 1		

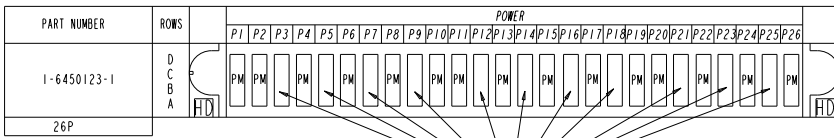

NO CONTACTS LOADED

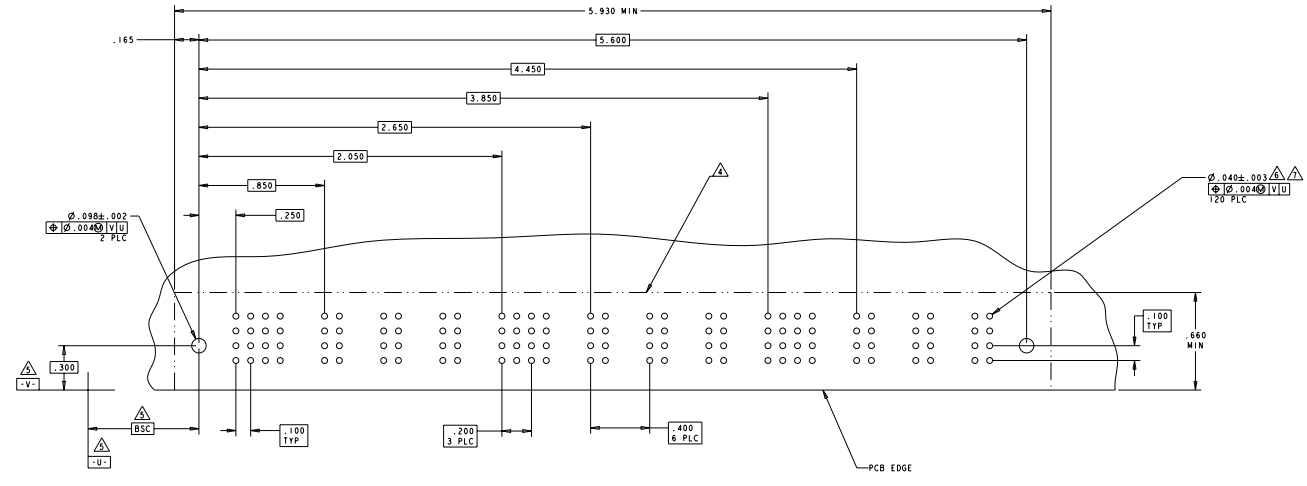

TECH ELECTRONICS CORPORATION		TECH ELECTRONICS		TECH ELECTRONICS	
INCHES	0.001 INCHES	0.001 INCHES	0.001 INCHES	0.001 INCHES	0.001 INCHES
DATE	10/13/13	DATE	10/13/13	DATE	10/13/13
REV	A	REV	A	REV	A
CUSTOMER DRAWING			CUSTOMER DRAWING		

REV	DATE	DESCRIPTION	BY	CHK
00		SEE SHEET 1		

PART NUMBER	ROWS	POWER							
		P1	P2	P3	P4	P5	P6	P7	P8
1-6450123-4	D C B A	PM	PM	PM	PM	PM	PM	PM	PM
8P		HD							HD

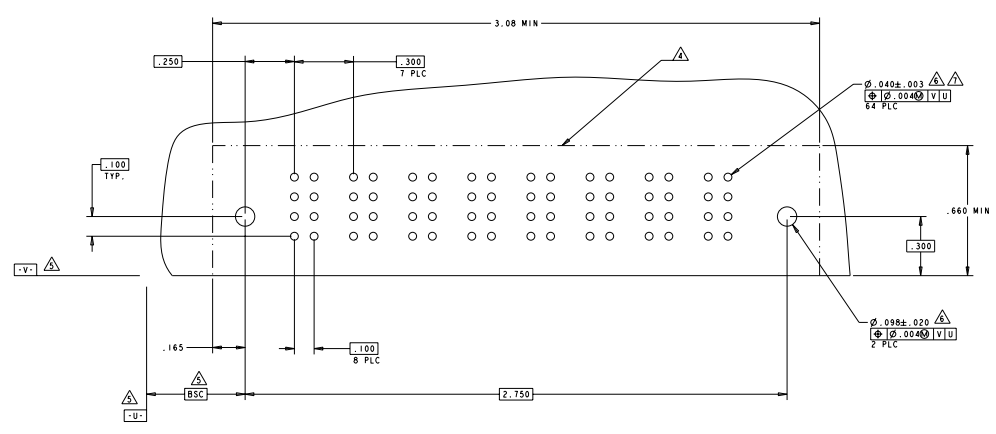

QUANTITY: 1000000 INCHES: 100-1313 SPECIFICATION: 116-1303B		CUSTOMER DRAWING: 00778 PART NUMBER: 1-6450123-4 TITLE: RIGHT ANGLE HEADER ASSEMBLY W/GUIDES MULTI-BEAM XL	
DATE: 00778 DRAWING NO: 1-6450123-4		SHEET: 2 OF 6 OF: 6	