

REVISED		REVISIONS			
INC	QTY	REV	DESCRIPTION	DATE	BY
GP	00	C4	ADDED NEW DASH NUMBER 1-6450543-2		

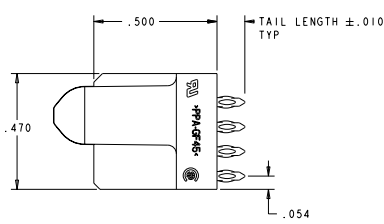
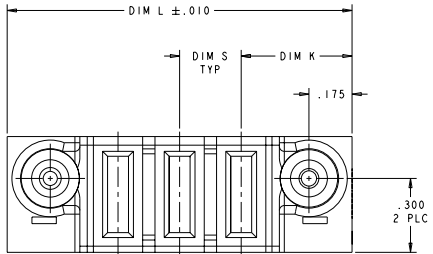
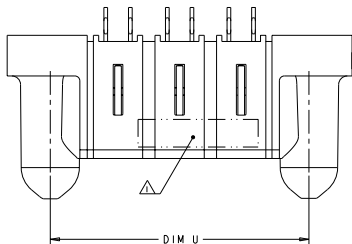
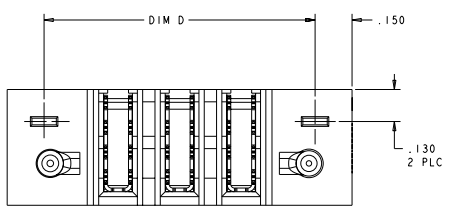

- △ "AMP", PART NUMBER AND DATE CODE TO BE MARKED IN AREA SHOWN PARTS 2.00 OR LESS MAYBE MARKED ON BOTH SIDES
- △ MATERIAL: HOUSING - GLASS FILLED HIGH TEMP THERMO PLASTIC, UL94 V-0 POWER CONTACT - HIGH CONDUCTIVITY COPPER ALLOY
- △ CONTACT PLATING: POWER CONTACTS - .000050 MIN Ni UNDER ALL .000030 MIN Au ON CONTACT AREA .000100 MIN Sn AT PCB INTERFACE
- △ MECHANICAL CONNECTOR KEEP OUT ZONE
- △ DATUM AND BASIC DIMENSIONS ESTABLISHED BY CUSTOMER
- △ PCB - ALL HOLE DIMENSIONS ARE FINISHED HOLE SIZES
- △ PCB - .0453 ±.0010 DRILLED HOLES, PLATED WITH .0003 MIN Sn OVER .001 TO .003 Cu PLATING TO ACHIEVE A .040 DIA HOLE
- △ FOR DETAIL DIMENSION, PLEASE REFER TO TALBE.

DIM U	DIM D	DIM S	DIM L	DIM K	DESCRIPTION	PART NUMBER
1.200	-	.300	1.550	.475	3ACP	1-6450543-2
5.550	5.600	.200	5.900	.450	26P	1-6450543-1
1.800	1.850	.250	2.150	.450	6P	1-6450543-0
1.800	1.850	.250	2.150	.450	6P	6450543-9
2.550	2.600	.250	2.900	.450	9P	6450543-8
2.150	2.200	.200	2.500	.450	9HDP	6450543-7
1.200	1.250	.300	1.550	.475	3ACP	6450543-6
1.300	1.350	.250	1.650	.450	4P	6450543-5
.800	-	.250	1.150	.450	2P	6450543-4
2.050	-	.250	2.400	.450	7P	6450543-3
1.300	-	.250	1.650	.450	4P	6450543-2
1.050	-	.250	1.400	.450	3P	6450543-1

**Vertical Receptacle Assembly with Guides Multi-Beam XL**

Part Number: 1-6450543-2

Customer Drawing

Scale: 1:1

Sheet: 1 of 4

Revision: C4

REVISOR		DESCRIPTION	DATE	BY
GP	00	SEE SHEET 1		

PART NUMBER	ROWS	POWER
6450543-1	D C B A	P3   P2   P1
	GP   GP   GP	

3P

PART NUMBER	ROWS	POWER
6450543-2	D C B A	P4   P3   P2   P1
	GP   GP   GP   GP	

4P

PART NUMBER	ROWS	POWER
6450543-3	D C B A	P7   P6   P5   P4   P3   P2   P1
	GP   GP   GP   GP   GP   GP   GP	

7P

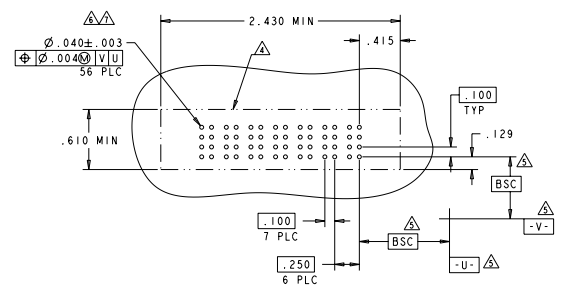
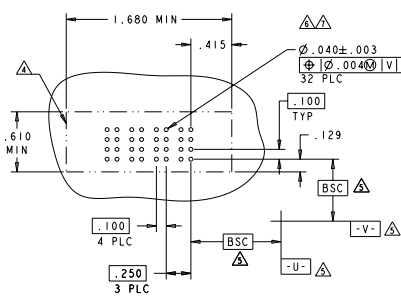
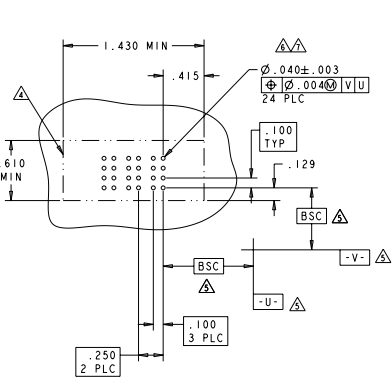

PART NUMBER	ROWS	POWER
6450543-5	D C B A	P4   P3   P2   P1
	HD   GP   GP   GP   HD	

4P

PART NUMBER	ROWS	POWER
6450543-4	D C B A	P2   P1
	GP   GP	

2P

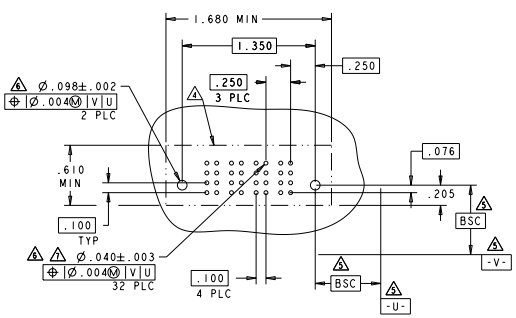
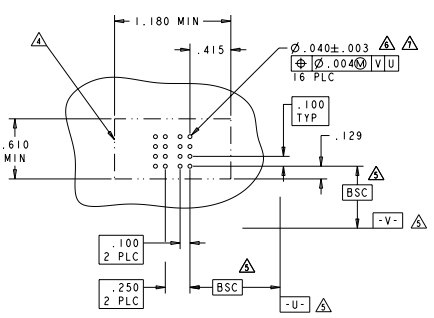

DATE: 08/24/2018	BY: TECH ELECTRONICS CORPORATION	ALL RIGHTS RESERVED	DATE: 08/24/2018	BY: TECH ELECTRONICS CORPORATION	ALL RIGHTS RESERVED
INCHES	UNITS	SCALE	1:1	DATE	08/24/2018
DESIGNED BY	DESIGNED BY	DESIGNED BY	DESIGNED BY	DESIGNED BY	DESIGNED BY
CHECKED BY	CHECKED BY	CHECKED BY	CHECKED BY	CHECKED BY	CHECKED BY
APPROVED BY	APPROVED BY	APPROVED BY	APPROVED BY	APPROVED BY	APPROVED BY
TECH ELECTRONICS CORPORATION HARRISBURG, PA 17105-3600			TECH ELECTRONICS CORPORATION HARRISBURG, PA 17105-3600		
PART NUMBER: 6450543-1			PART NUMBER: 6450543-1		
DESCRIPTION: VERTICAL RECEPTACLE ASSEMBLY WITH GUIDES MULTI-BEAM XL			DESCRIPTION: VERTICAL RECEPTACLE ASSEMBLY WITH GUIDES MULTI-BEAM XL		
REV: 00			REV: 00		
DRAWN: 116-13038			DRAWN: 116-13038		
CHECKED: 00778			CHECKED: 00778		
APPROVED: 00778			APPROVED: 00778		
CUSTOMER DRAWING			CUSTOMER DRAWING		

REV	REVISOR	DATE	DESCRIPTION	PART	QTY
1	SEE SHEET 1				

PART NUMBER	ROWS	POWER				
		P3	P2	P1		
6450543-6	D C B A	GS	GS	GS		
3ACP		HD				HD

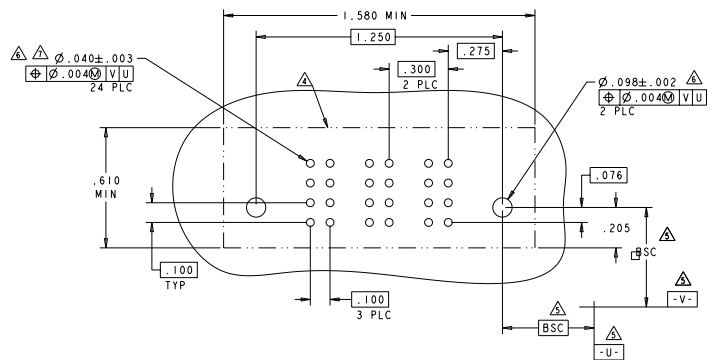

PART NUMBER	ROWS	POWER								
		P9	P8	P7	P6	P5	P4	P3	P2	P1
6450543-7	D C B A	HS	HS	HS	HS	HS	HS	HS	HS	HS
9HDP										

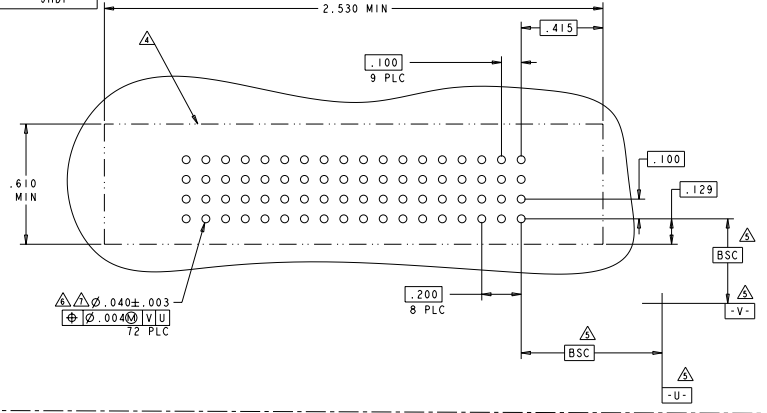

PART NUMBER	ROWS	POWER								
		P9	P8	P7	P6	P5	P4	P3	P2	P1
6450543-8	D C B A	GS	GS	GS	GS	GS	GS	GS	GS	GS
9P										

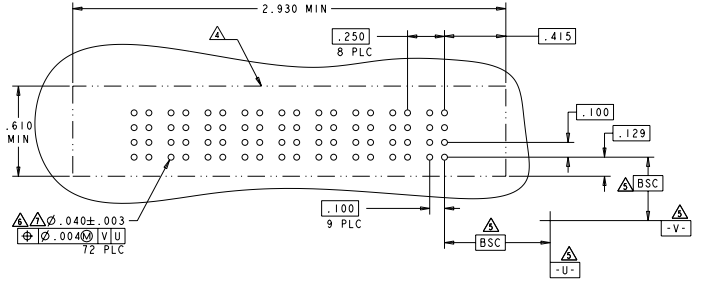

PART NUMBER	ROWS	POWER					
		P6	P5	P4	P3	P2	P1
6450543-9	D C B A	GS	GS	GS	GS	GS	GS
6P		HD					HD

THE PCB LAYOUT IS FOR P/N 6450543-9  
 ADN 6450543-10.

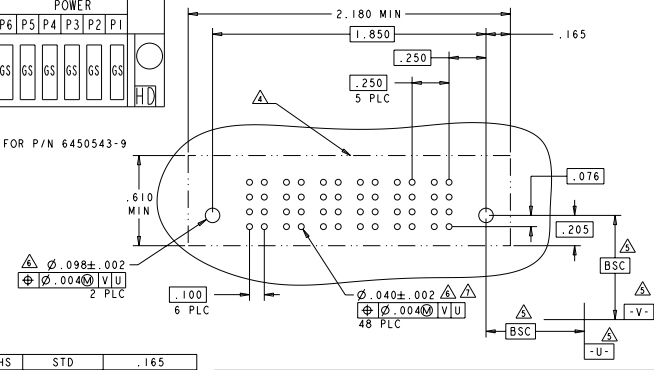

HS	STD	.165
GS	STD	.135
GP	MFBL	.135
VS	STD	.115
YP	MFBL	.115

INCHES	FRONT VIEW	DATE	17MAY85	APP. BY	TRAVES	DATE	17MAY85	DESIGNED BY	TRAVES
INCHES	REAR VIEW	DATE	17MAY85	APP. BY	TRAVES	DATE	17MAY85	DESIGNED BY	TRAVES
INCHES	TOP VIEW	DATE	17MAY85	APP. BY	TRAVES	DATE	17MAY85	DESIGNED BY	TRAVES
INCHES	BOTTOM VIEW	DATE	17MAY85	APP. BY	TRAVES	DATE	17MAY85	DESIGNED BY	TRAVES
INCHES	RIGHT SIDE VIEW	DATE	17MAY85	APP. BY	TRAVES	DATE	17MAY85	DESIGNED BY	TRAVES
INCHES	LEFT SIDE VIEW	DATE	17MAY85	APP. BY	TRAVES	DATE	17MAY85	DESIGNED BY	TRAVES
INCHES	ISOMETRIC	DATE	17MAY85	APP. BY	TRAVES	DATE	17MAY85	DESIGNED BY	TRAVES
INCHES	SECTION	DATE	17MAY85	APP. BY	TRAVES	DATE	17MAY85	DESIGNED BY	TRAVES
INCHES	OTHER	DATE	17MAY85	APP. BY	TRAVES	DATE	17MAY85	DESIGNED BY	TRAVES

VERTICAL RECEPTACLE ASSEMBLY WITH GUIDES MULTI-BEAM XL  
 STATE CASE CODE DRAWING NO. 00778 ©-6450543  
 CUSTOMER DRAWING

REV	DATE	DESCRIPTION	BY	CHK	APP
GP	00	SEE SHEET 1			

PART NUMBER	ROWS	POWER						
		P6	P5	P4	P3	P2	P1	
I-6450543-0	D C B A	○	VS	VS	VS	VS	VS	○
6P		HD						HD

PCB LAYOUT IS THE SAME AS PN 6450543-9'S, PLEASE REFER TO SHEET 3.

PART NUMBER	ROWS	POWER																								
		P26	P25	P24	P23	P22	P21	P20	P19	P18	P17	P16	P15	P14	P13	P12	P11	P10	P9	P8	P7	P6	P5	P4	P3	P2
I-6450543-1	D C B A	○	GP	GS	GP	GS	GP	GP	GP	GS	GP	GS	GP	GS	GP	GS	GP	GS	GP	GS	GP	GS	GP	GS	GP	○
26P																										

NO CONTACTS LOADED

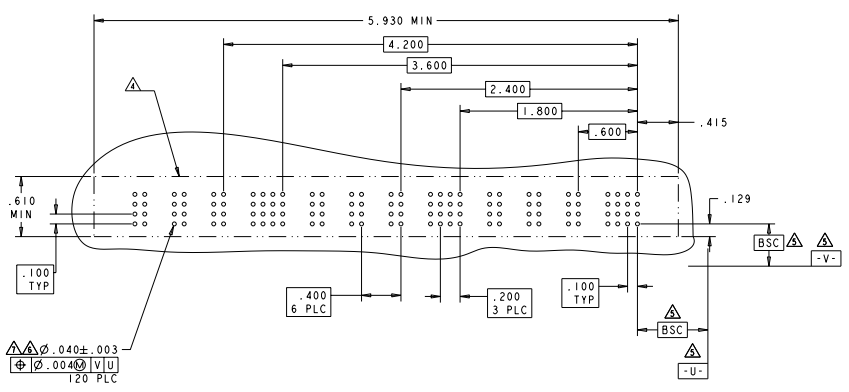

TYP. DIMENSIONS IN INCHES UNLESS OTHERWISE SPECIFIED DIMENSIONS IN MILLIMETERS UNLESS OTHERWISE SPECIFIED		TYP. DIMENSIONS IN MILLIMETERS UNLESS OTHERWISE SPECIFIED DIMENSIONS IN INCHES UNLESS OTHERWISE SPECIFIED	
DIMENSIONS IN INCHES DIMENSIONS IN MILLIMETERS	DIMENSIONS IN INCHES DIMENSIONS IN MILLIMETERS	DIMENSIONS IN INCHES DIMENSIONS IN MILLIMETERS	DIMENSIONS IN INCHES DIMENSIONS IN MILLIMETERS
CUSTOMER DRAWING DATE: 108-1913 DRAWN BY: J. J. B.	CUSTOMER DRAWING DATE: 108-1913 DRAWN BY: J. J. B.	CUSTOMER DRAWING DATE: 108-1913 DRAWN BY: J. J. B.	CUSTOMER DRAWING DATE: 108-1913 DRAWN BY: J. J. B.

DATE SHOWN IN DIMENSIONS RECEIVED FOR FABRICATION  
 0000000000 BY TECH ELECTRONICS CORPORATION ALL RIGHTS RESERVED

REV	DATE	REVISIONS		
		BY	APP	DATE
00	GP	SEE SHEET 1		

PART NUMBER	ROWS	POWER		
		P3	P2	P1
1-6450543-2	D C B A	GS	GS	GS
3ACP				

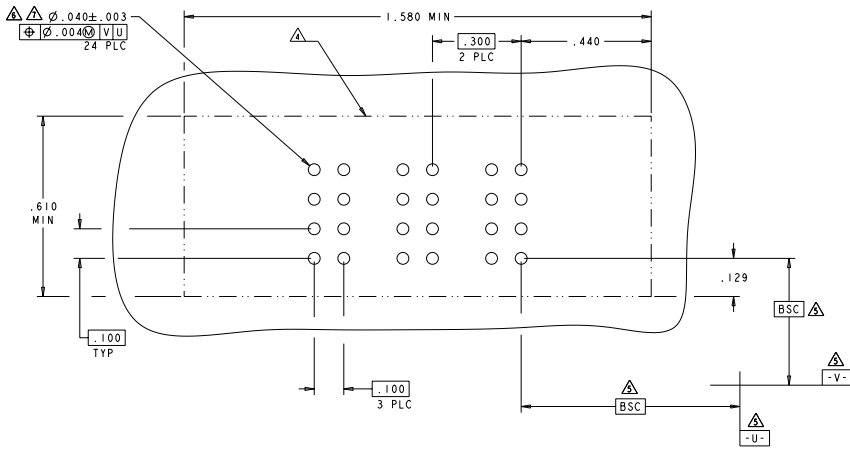

TECHNICAL SPECIFICATIONS		MATERIALS		TOLERANCES		FINISHES		MARKINGS	
INCHES	DECIMALS	PLC	PLC	PLC	PLC	PLC	PLC	PLC	PLC
VERTICAL RECEPTACLE ASSEMBLY WITH GUIDES MULTI-BEAM XL		100-1913		116-13038		A		00778	
CUSTOMER DRAWING		100-1913		116-13038		A		00778	