

THIS COPY IS PROVIDED ON A RESTRICTED BASIS AND IS NOT TO BE USED IN ANY WAY DETRIMENTAL TO THE INTERESTS OF PANDUIT CORP.

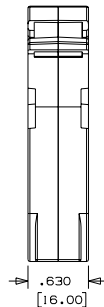
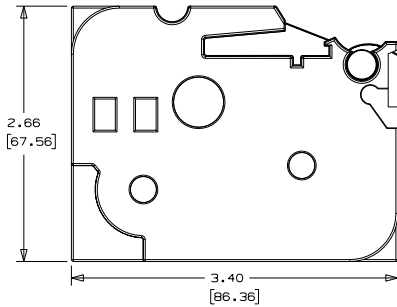
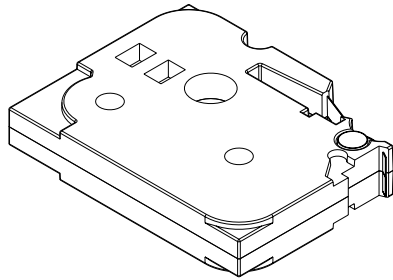

PART NUMBER	MARKER SIZE	MATERIAL
LS7-25-1	.236 X 26.2 (6.00 X 8.0)	BLK/WHT LAM. POLYESTER
LS7-25-2	.236 X 26.2 (6.00 X 8.0)	BLK/CLEAR LAM. POLYESTER
LS7-38-1	.354 X 26.2 (9.00 X 8.0)	BLK/WHT LAM. POLYESTER
LS7-38-2	.354 X 26.2 (9.00 X 8.0)	BLK/CLEAR LAM. POLYESTER
LS7-50-1	.472 X 26.2 (12.00 X 8.0)	BLK/WHT LAM. POLYESTER
LS7-50-2	.472 X 26.2 (12.00 X 8.0)	BLK/CLEAR LAM. POLYESTER
LS7-75-4	.708 X 26.2 (18.00 X 8.0)	BLK/YEL LAM. POLYESTER
LS7-75-5	.708 X 26.2 (18.00 X 8.0)	BLK/ORN LAM. POLYESTER
LS7-75-6	.708 X 26.2 (18.00 X 8.0)	BLK/RED LAM. POLYESTER
LS7-75NL-1	.708 X 26.2 (18.00 X 8.0)	BLK/WHT NON-LAM. POLYESTER
LS7-75NL-2	.708 X 26.2 (18.00 X 8.0)	BLK/CLEAR NON-LAM. POLYESTER
LS7-ACS	.236 X 26.2 (6.00 X 8.0)	BLK/WHT LAM. POLYESTER
LS7-CLN	.236 X 26.2 (6.00 X 8.0)	BLK/WHT LAM. POLYESTER
U1LS7BW	.236 X 26.2 (6.00 X 8.0)	BLK/WHT NON-LAM. POLYESTER

NOTES:  
1. DIMENSIONS IN [ ]  
ARE IN MILLIMETERS.

CAD FILENAME/VERSION: 00743BC_C10425_LS7CASSETTE_00.prt										
<b>PANDUIT</b> CORP TINLEY PARK, ILLINOIS										
CUSTOMER DRAWING LS7 CASSTTE										
UNLESS OTHERWISE SPECIFIED, DIMENSIONAL TOLERANCES ARE: (.X) ± (.XX) ±					UNLESS OTHERWISE SPECIFIED, ALL DIMENSIONS ARE GIVEN IN INCHES, THIRD ANGLE PROJECTION					
0	6-20-06	RVU	ENGINEERING RELEASE.			4561	R			
REV	DATE	BY	CHK	DESCRIPTION	ECN	R	CUST	SUP	DRAWN BY: RVU	MAT'L: CASSETTE - THERMOPLASTIC
									DATE: 6-20-06	SCALE: FULL
									CHK'D	DWG NO. C10425
										DWG SIZE B