

THIS DRAWING IS UNPUBLISHED  
 ALL RIGHTS RESERVED

REV	DATE	DESCRIPTION	BY	APP
AD	25			
R		REVISED PER ECO 0212-0287-05	13MAY06	JDF/AMS
R1		REVISED PER ECO-09-021510	12SEP09	KK/AEG

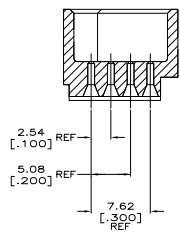

SECTION S-S

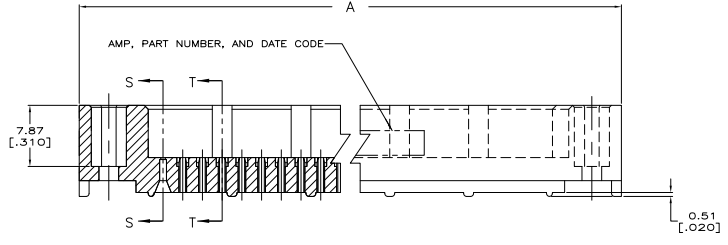
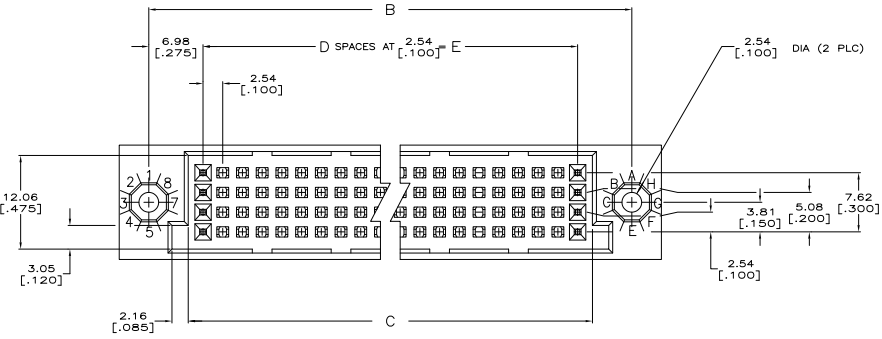
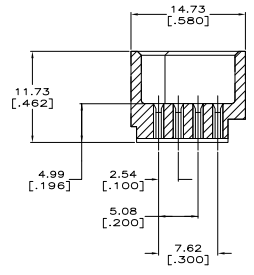

SECTION T-T

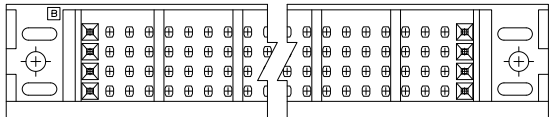

THIS DRAWING IS A CONTROLLED DOCUMENT.		DESIGNED BY: <b>WV/VN</b>	DATE: <b>02/12/06</b>	REVISED BY: <b>WV/VN</b>	DATE: <b>02/12/06</b>
DRAWN BY: <b>WV/VN</b>		CHECKED BY: <b>WV/VN</b>	DATE: <b>02/12/06</b>	APPROVED BY: <b>WV/VN</b>	DATE: <b>02/12/06</b>
DIMENSIONS IN INCHES		TWO ELECTRONICS CORPORATION Harrisburg, PA 17105-3608			
PART NUMBER: <b>000779</b>		HDI, 4 ROW, PIN SHROUD			
REV: <b>1</b>		SIZE: <b>A1</b>		DRAWING NO: <b>000779</b>	
MATERIAL: <b>BRASS</b>		REVISED BY: <b>WV/VN</b>		REVISED DATE: <b>09/02/09</b>	
SPEC: <b>ASSEMBLY</b>		CUSTOMER DRAWING		PAGE: <b>1</b> OF <b>2</b>	

AMP 485 REV 2/2005

THIS DRAWING IS UNPUBLISHED. ALL RIGHTS RESERVED.  
 © 2008 TTI ELECTRONICS CORPORATION

REV	DATE	DESCRIPTION	BY	CHK	APP
AD 25		SEE SHEET 1			

- △ HOUSING MATERIAL: THERMOPLASTIC, COLOR-NATURAL.
- 2. DIMENSIONS IN BRACKETS ARE IN INCHES.
- △ PART NUMBER IS OBSOLETE.
- △ OBSOLETE PARTS: OBSOLETE CIS STREAMLINING PER D.RENAUD/D.SINISI

△	200.66	79	204.47	214.63	222.25	320	2-533562-6			
	[7.900]		[8.050]	[8.450]	[8.750]					
△ OBSOLETE	187.96	74	191.77	201.93	209.55	300	1-533562-2			
	[7.400]		[7.550]	[7.950]	[8.250]					
△	175.26	69	179.07	189.23	196.85	280	1-533562-1			
	[6.900]		[7.050]	[7.450]	[7.750]					
△	182.56	64	166.37	176.53	184.15	260	1-533562-0			
	[6.400]		[6.550]	[6.950]	[7.250]					
△	149.86	59	153.67	163.83	171.45	240	533562-9			
	[5.900]		[6.050]	[6.450]	[6.750]					
△	137.16	54	140.97	151.13	158.75	220	533562-8			
	[5.400]		[5.550]	[5.950]	[6.250]					
△	124.46	49	128.27	138.43	146.05	200	533562-7			
	[4.900]		[5.050]	[5.450]	[5.750]					
△	111.76	44	115.57	125.73	133.35	180	533562-6			
	[4.400]		[4.550]	[4.950]	[5.250]					
△	99.06	39	102.87	113.03	120.65	160	533562-5			
	[3.900]		[4.050]	[4.450]	[4.750]					
△	86.36	34	90.17	100.33	107.95	140	533562-4			
	[3.400]		[3.550]	[3.950]	[4.250]					
△	78.74	31	82.55	92.71	100.33	120	533562-3			
	[3.100]		[3.250]	[3.650]	[3.950]					
△ OBSOLETE	73.66	29	77.47	87.63	95.25	120	533562-2			
	[2.900]		[3.050]	[3.450]	[3.750]					
△	60.96	24	64.77	74.93	82.55	100	533562-1			
	[2.400]		[2.550]	[2.950]	[3.250]					
	E	D	C	B	A	POSN	PART NO.			

THIS DRAWING IS A CONTROLLED DOCUMENT.		DESIGNED BY: <b>SKP/ST</b>	DATE: <b>05/04/08</b>	Checked by: <b>SKP/ST</b>	DATE: <b>05/04/08</b>
DRAWN BY: <b>SKP/ST</b>		DATE: <b>05/04/08</b>	Title Electronics Corporation Harrisburg, PA 17106-3608		
PART NO. <b>533562</b>		HDI, 4 ROW, PIN SHROUD			
REV. <b>1</b>		DATE <b>05/04/08</b> DRAWN BY <b>SKP/ST</b> CHECKED BY <b>SKP/ST</b>			
MATERIAL <b>PCB</b>		REV. <b>1</b> DATE <b>05/04/08</b> DRAWN BY <b>SKP/ST</b> CHECKED BY <b>SKP/ST</b>			
PROPERTY <b>TTI</b>		REV. <b>1</b> DATE <b>05/04/08</b> DRAWN BY <b>SKP/ST</b> CHECKED BY <b>SKP/ST</b>			
CUSTOMER DRAWING		REV. <b>1</b> DATE <b>05/04/08</b> DRAWN BY <b>SKP/ST</b> CHECKED BY <b>SKP/ST</b>			