

THIS DRAWING IS UNAPPROVED
 RELEASED FOR PRODUCTION
 BY AMP INCORPORATED. ALL RIGHTS RESERVED.

* AMPPOWER is a trademark

REV	DATE	DESCRIPTION	BY	CHK	APP
0		RELEASED FOR PRODUCTION	DAVID	DAVID	DAVID
A	0820-0118-99	ECO-09-024717	DAVID	DAVID	DAVID
AT1		REVISED PER ECO-09-024717	DAVID	DAVID	DAVID

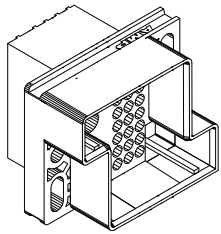
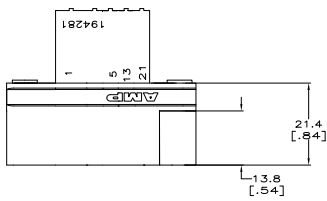

1. MATERIAL: POLYESTER PCT, BLACK.
 2. POSITIONS 1-4 ARE FOR 3mm CONTACTS.
 3. POSITIONS 5-28 ARE FOR SIZE 16 CONTACTS.
 4. ALL DIMENSIONS EXCEPT PANEL CUT OUTS ARE REFERENCE ONLY.
- ⚠️ OBSOLETE PARTS: OBSOLETE CIS STREAMLINING PER D.RENAUD/D.SINISI

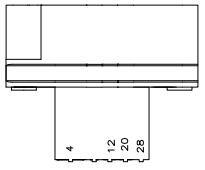
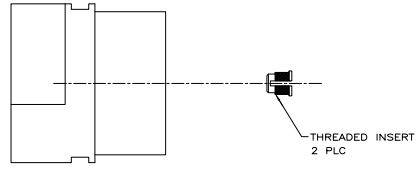
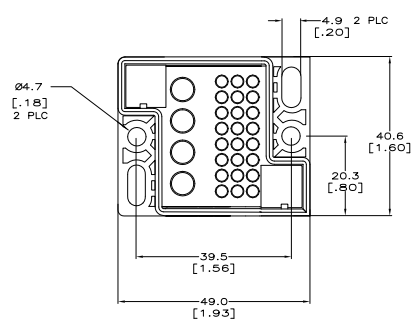

⚠️ OBSOLETE	#6-32 THREADED INSERT (REAR MOUNTED)	194281-4
	NO INSERTS	194281-1
	DESCRIPTION	PART NO

AMP AMP Incorporated Harrisburg, PA 17105-3608	
DRAWING NO: 194281-1 REV: 1 DATE: 08/20/99	CUSTOMER DRAWING DATE: NONE SHEET: 2 OF: AT1

THIS DRAWING IS UNCONTROLLED
 RELEASED FOR PURCHASE
 © Copyright 19 by AMP Incorporated. ALL RIGHTS RESERVED.

REV	DATE	DESCRIPTION	BY	CHK
1	194281			
REVISIONS				
CH	11	SEE SHEET 1		

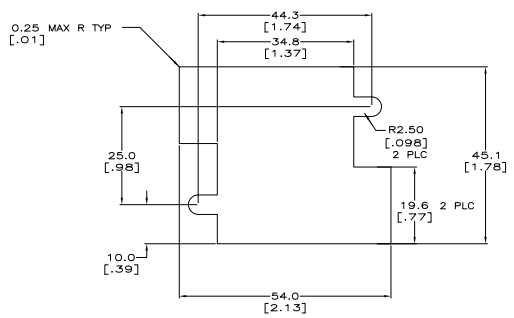

RECOMMENDED FLOAT MOUNT PANEL CUTOUT
 EXTERNAL VIEW

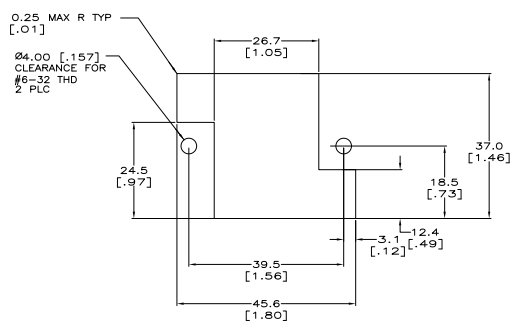

RECOMMENDED STATIONARY MOUNT PANEL CUTOUT
 EXTERNAL VIEW

THIS DRAWING IS A CONTROLLED DOCUMENT.		DESIGNED BY D. A. PLENIER	REVISED BY N. VAN	AMP Incorporated Harrisburg, PA 17105-3608
DRAWING NO. A1 00779	QUANTITY 1	DATE 10/10/00	PROJECT NO. -	AMP POWER Multi Pin Plus RECEPTACLE 20 POSITION
CUSTOMER DRAWING	SCALE NONE	UNIT INCH	REV 2	REV A 1