

REV	DATE	DESCRIPTION	BY	APP'D
AD 25				
01		REVISED FOR ECO-08-013375	DH	DB

- △ HOUSING MATERIAL: GLASS-FILLED POLYMER.
- △ POST AND GROUND PLATE MATERIAL: COPPER ALLOY.
- △ POST FINISH: DIN 41612 CLASS 2 IN CONTACT AREA. TIN PLATE ON POSTS.
- △ GROUND PLATE FINISH: DIN 41612 CLASS 2 IN CONTACT AREA. TIN PLATE ON POSTS.
- △ RECOMMENDED HOLE SIZE FOR MANUAL APPLICATION OF CONNECTOR ONTO PC BOARD.
- △ MOLD REVISION DATE CODE MOLDED IN THIS AREA.

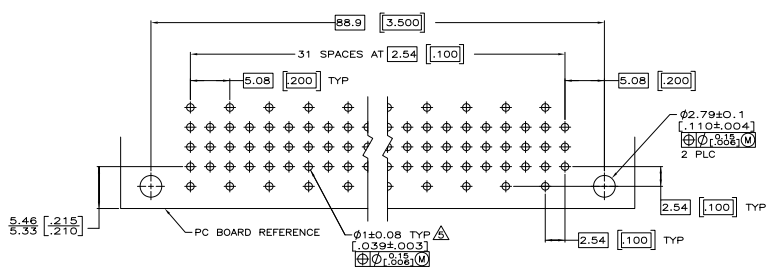
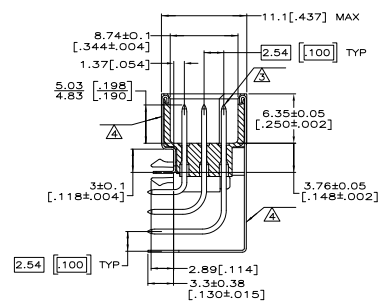
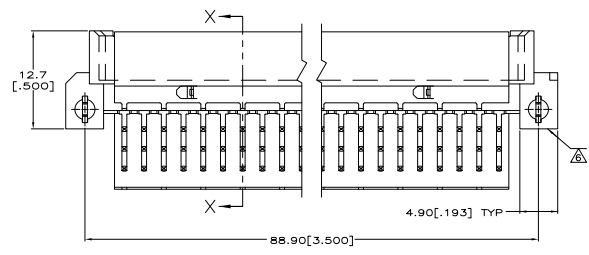
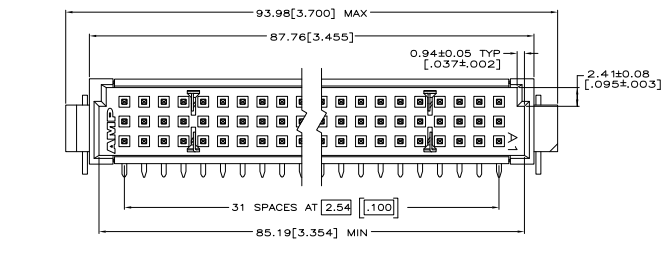

PC BOARD LAYOUT

THIS DRAWING IS A CONTROLLED DOCUMENT.		REV	DATE	DESCRIPTION	BY	APP'D
AD 25						
01						

INCHES	DECIMALS	FRACTIONS	OTHER
1/16	0.0005	1/32	
1/8	0.0010	1/16	
3/16	0.0015	3/32	
1/4	0.0020	1/8	
5/16	0.0025	3/16	
3/8	0.0030	1/4	
7/16	0.0035	5/16	
1/2	0.0040	3/8	
5/8	0.0045	1/2	
3/4	0.0050	5/8	
7/8	0.0055	3/4	
1	0.0060	7/8	
1 1/8	0.0065	1	
1 1/4	0.0070	1 1/8	
1 3/8	0.0075	1 1/4	
1 1/2	0.0080	1 3/8	
1 5/8	0.0085	1 1/2	
1 3/4	0.0090	1 5/8	
1 7/8	0.0095	1 3/4	
2	0.0100	1 7/8	
2 1/8	0.0105	2	
2 1/4	0.0110	2 1/8	
2 3/8	0.0115	2 1/4	
2 1/2	0.0120	2 3/8	
2 5/8	0.0125	2 1/2	
2 3/4	0.0130	2 5/8	
2 7/8	0.0135	2 3/4	
3	0.0140	2 7/8	
3 1/8	0.0145	3	
3 1/4	0.0150	3 1/8	
3 3/8	0.0155	3 1/4	
3 1/2	0.0160	3 3/8	
3 5/8	0.0165	3 1/2	
3 3/4	0.0170	3 5/8	
3 7/8	0.0175	3 3/4	
4	0.0180	3 7/8	
4 1/8	0.0185	4	
4 1/4	0.0190	4 1/8	
4 3/8	0.0195	4 1/4	
4 1/2	0.0200	4 3/8	
4 5/8	0.0205	4 1/2	
4 3/4	0.0210	4 5/8	
4 7/8	0.0215	4 3/4	
5	0.0220	4 7/8	
5 1/8	0.0225	5	
5 1/4	0.0230	5 1/8	
5 3/8	0.0235	5 1/4	
5 1/2	0.0240	5 3/8	
5 5/8	0.0245	5 1/2	
5 3/4	0.0250	5 5/8	
5 7/8	0.0255	5 3/4	
6	0.0260	5 7/8	
6 1/8	0.0265	6	
6 1/4	0.0270	6 1/8	
6 3/8	0.0275	6 1/4	
6 1/2	0.0280	6 3/8	
6 5/8	0.0285	6 1/2	
6 3/4	0.0290	6 5/8	
6 7/8	0.0295	6 3/4	
7	0.0300	6 7/8	
7 1/8	0.0305	7	
7 1/4	0.0310	7 1/8	
7 3/8	0.0315	7 1/4	
7 1/2	0.0320	7 3/8	
7 5/8	0.0325	7 1/2	
7 3/4	0.0330	7 5/8	
7 7/8	0.0335	7 3/4	
8	0.0340	7 7/8	
8 1/8	0.0345	8	
8 1/4	0.0350	8 1/8	
8 3/8	0.0355	8 1/4	
8 1/2	0.0360	8 3/8	
8 5/8	0.0365	8 1/2	
8 3/4	0.0370	8 5/8	
8 7/8	0.0375	8 3/4	
9	0.0380	8 7/8	
9 1/8	0.0385	9	
9 1/4	0.0390	9 1/8	
9 3/8	0.0395	9 1/4	
9 1/2	0.0400	9 3/8	
9 5/8	0.0405	9 1/2	
9 3/4	0.0410	9 5/8	
9 7/8	0.0415	9 3/4	
10	0.0420	9 7/8	

5536149-5	ASSY PART NUMBER
TTS Electronics Corporation Harrisburg, PA 17105-3608	
ASSEMBLY, PIN, ENHANCED, TYPE C, EUROCARD, 5 ROW, SOLDER, 3.30[130] WITH BOARD-LOCKS	REVISED TO
DATE 00779	DATE 00779
SIZE 4.1	REV 1
Q=5536149	REV 01