

4

3

2

1

THIS DRAWING IS UNPUBLISHED. RELEASED FOR PUBLICATION NOV. 2004.  
 © COPYRIGHT 2004 BY TYCO ELECTRONICS CORPORATION. ALL RIGHTS RESERVED.

LOC	DIST	REVISIONS			
P	LTR	DESCRIPTION	DATE	DWN	APVD
A		REVISED ECR-08-020578	18NOV08	T.T	T.F
A1		REVISED PER ECO-09-024927	09NOV09	KK	AE

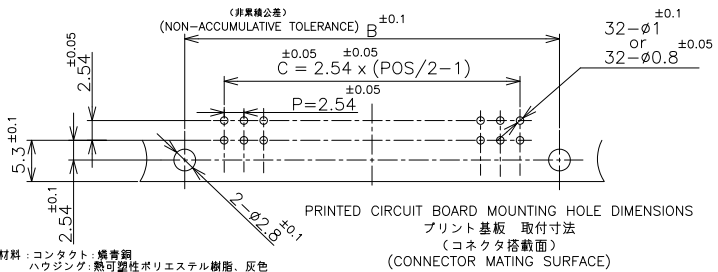
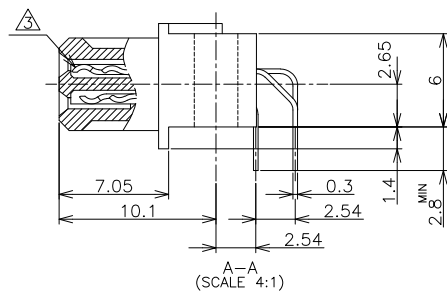
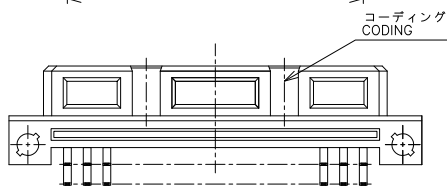
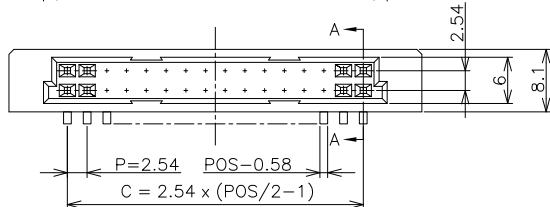
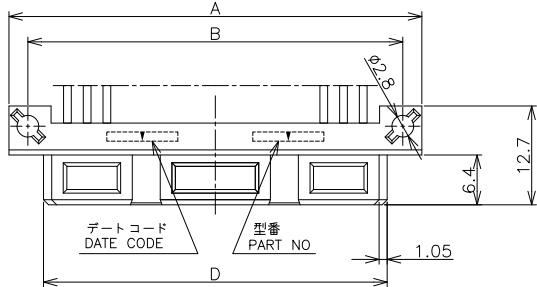

- 材料: コンタクト: 磷青銅  
ハウジング: 熱可塑性ポリエステル樹脂、灰色
  - 表面仕上げ (コンタクト)
- | 下地めっき | タイン部 | コンタクト接触部    | その他  |
|-------|------|-------------|------|
| ニッケル  | 錫めっき | 金めっき (0.2μ) | 封孔処理 |
- ランドコンタクト: b列 NO.1, 32 に配置 (2箇所) - 64極 (P/N 5174253-2)  
: b列 NO.1, 16 及び 5b に配列 (3箇所) - 32極 (5174253-3)  
P/N 5174253-1 32極 b列 NO.1, 16 にランド配列 (2箇所)  
寸法は -3 と同様
  - 64極 b列 NO.1, 32 及び 2b, 31b にランド配列 (4箇所)  
寸法は -2 と同様

- MATERIAL: CONTACT: PHOSPHOR BRONZE  
HOUSING: THERMOPLASTIC POLYESTER RESIN, GRAY
  - FINISH (CONTACT)
- | UNDER PLATE | TIN AREA | CONTACT AREA | REMAINDER AREA  |
|-------------|----------|--------------|-----------------|
| NICKEL      | TIN      | GOLD(0.2μ)   | PORSPITY SEALED |
- GROUNDING CONTACTS: ON NO.1 & NO.32 (2 PL) IN ROW b FOR 64-POS. (P/N 5174253-2)  
ON NO.1 & NO.16 AND NO.5b (3 PL) FOR 32-POS. (P/N 5174253-3)  
DIMENSIONS TYPICAL TO -3.
  - GROUNDING CONTACTS: ON NO.1 & NO.16 (2 PL) IN b ROW FOR 32-POS. (P/N 5174253-1)  
DIMENSIONS TYPICAL TO -3.
  - GROUNDING CONTACTS: ON NO.1 & NO.32 AND NO.2b, 31b (4 PL) (P/N 5174253-4)  
DIMENSIONS TYPICAL TO -2.
  - OBsolete PARTS: OBSOLETE CIS STREAMLINING PER D.RENAUD/D.SINISI

OBSOLETE	PART NO.	POS	CODING LOCATIONS			
			A	B	C	D
4	64	93.8	88.9	78.74	84.9	6, 13, 20, 27
	32	53.1	48.24	38.1	44.2	4.12
-2	64	93.8	88.9	78.74	84.9	6, 13, 20, 27
	32	53.1	48.24	38.1	44.2	4.12

THIS DRAWING IS A CONTROLLED DOCUMENT.

DIMENSIONS: 単位: 純 mm	TOLERANCES UNLESS OTHERWISE SPECIFIED: 公差	DWN T.KIMURA 30NOV04	CHK K.IKEGAMI 30NOV04	APVD K.IKEGAMI 30NOV04	NAME 名称 DR DIN CONN. FEMALE ASSY WITH GROUND
0 PLC ±0.2 1 PLC ±0.2 2 PLC ±0.2 3 PLC ±0.2 4 PLC ±0.2 ANGLES ±0.2	FINISH 仕上	Tyco Electronics Tyco Electronics Corporation Kawasaki, Japan			SIZE A3
MATERIAL 材料 SEE NOTE	SEE NOTE	PRODUCT SPEC 製品規格			CAGE CODE 00779
		APPLICATION SPEC 取付適用規格			DRAWING NO 番号 5174253
		WEIGHT			RESTRICTED TO
		CUSTOMER DRAWING			SCALE 尺度 2:1
		SHEET 1 of 1			REV A1