

THIS DRAWING IS UNPUBLISHED.
 © COPYRIGHT BY TYCO ELECTRONICS CORPORATION. ALL RIGHTS RESERVED.
 RELEASED FOR PUBLICATION

LOC	DIST	REV	DATE	BY	APP
AJ	16	G	12-02-04	JDP	CM
REV PER		OS14-0252-04			

REV	DATE	BY	APP
1			

- 1 BRASS PER QQ-B-626.
 - 2 PTFE PER MIL-P-19468.
 - 3 PHOSPHOR BRONZE PER QQ-B-750.
 - 4 BERYLLIUM COPPER PER QQ-C-530.
 - 5 TIN PLATE PER ASTM-B-545.
 - 6 COPPER PLATE PER MIL-C-14550.
 - 7 NICKEL PLATE PER QQ-N-290.
 - 8 GOLD PLATE PER MIL-G-45204.
9. DIELECTRIC AND CONTACT ASSEMBLY WILL WITHSTAND 2.5 LB PUSHOUT FORCE DIRECTED FROM MATING END.

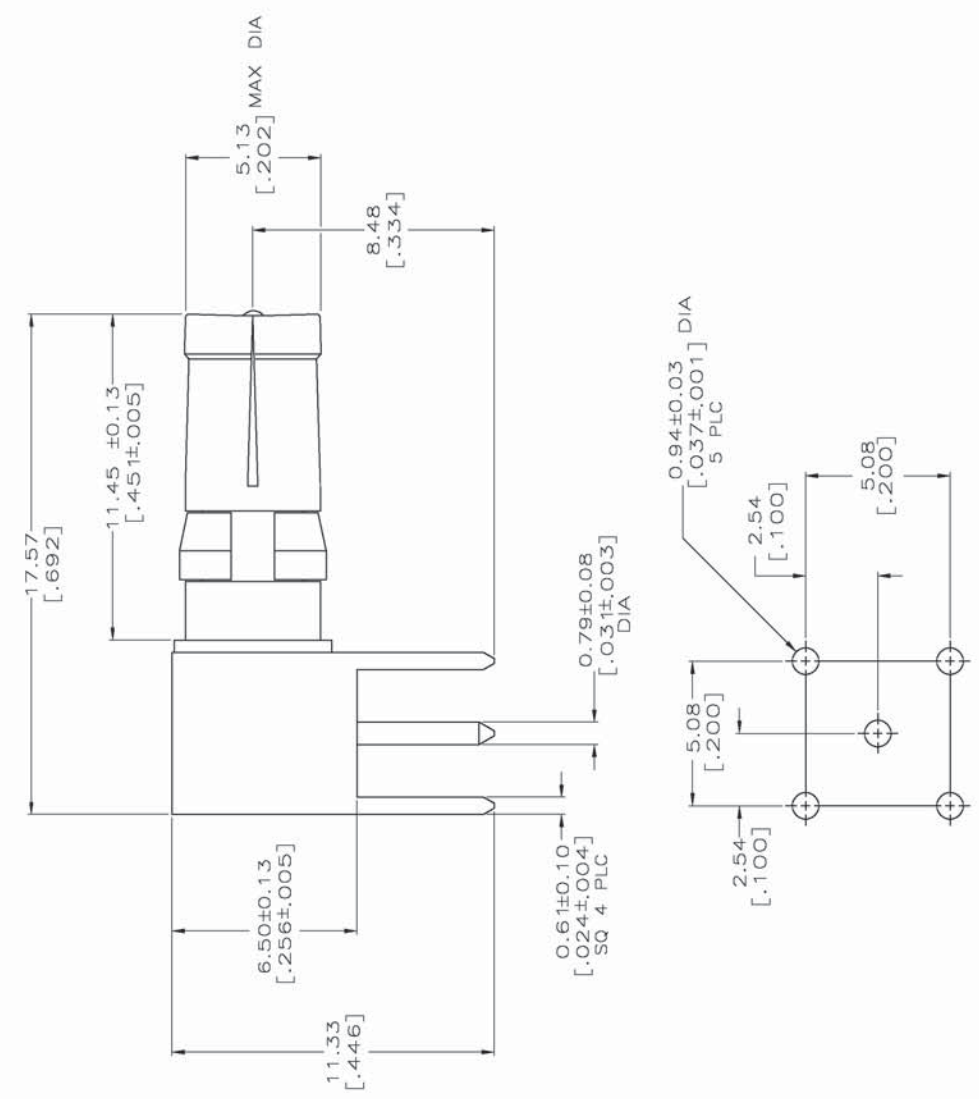

PCB CONFIGURATION

OBSOLETE	221162-2
	221162-1
	PART NUMBER

THIS DRAWING IS A CONTROLLED DOCUMENT.		DR H. B. JOHNSON 09-20-91	Ytyco Electronics	Tyco Electronics Corporation Harrisburg, Pa 17105-3608
DESIGNED BY	WERNER 09-29-91	APPROVED BY	D. DOTE 09-3-91	NAME
INCHES	1/8" PLG ± .010	PRODUCT SPEC	APPLICATION SPEC	SIZE
DISCREPANCY	1/8" PLG ± .010	WEIGHT		DATE CODE
FINISH	ANGLES ± .03"			221162
MATERIAL				RESTRICTED TO
				SOCKET/PCB/RIGHT ANGLE
				SIZE B, HDI
				SCALE 1:1
				SHEET 1 OF 1
				REV G