

4

3

2

1

THIS DRAWING IS UNPUBLISHED. RELEASED FOR PUBLICATION
 © COPYRIGHT BY TYCO ELECTRONICS CORPORATION. ALL RIGHTS RESERVED.

LOC	DIST	REVISIONS					
AD	00	F	LN	DESCRIPTION	DATE	BY	APP'D
		B		REV PER EC 0512-0302-05	14DEC05	BC	GS
		C		ECR-10-019054	15SEP10	DP	MQW

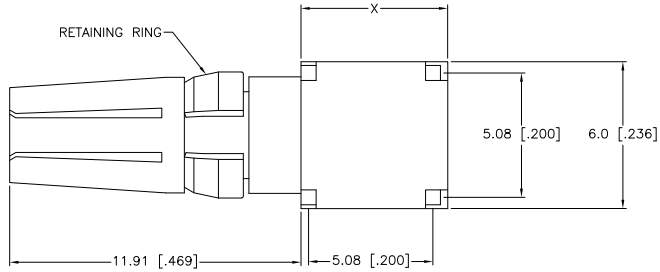
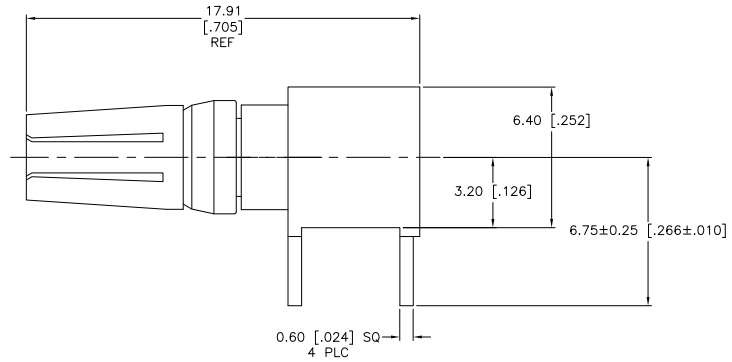

- 1 SUITABLE FOR FEMALE TYPE M CONNECTORS.
- 2 CONTACT SPRING: BERYLLIUM COPPER.
CONTACT BODY: BRASS.
RETAINING RING: BERYLLIUM COPPER.
- 3 CONTACT FINISH: 0.00127[.000050] MIN GOLD IN CONTACT AREA,
0.00254[.000100] MIN TIN IN AREA "X", ALL OVER
0.00127[.000050] NICKEL.
- 4 CONTACT FINISH: 0.00076[.000030] MIN GOLD IN CONTACT AREA,
0.00254[.000100] MIN TIN IN AREA "X", ALL OVER
0.00127[.000050] NICKEL.

OBSOLETE	4	5148513-2
	3	5148513-1
		FINISH PART NUMBER

THIS DRAWING IS A CONTROLLED DOCUMENT.		DRN	B CARBO	15JUL05	Tyco Electronics Corporation Harrisburg, PA 17105-3608
DIMENSIONS: mm [INCHES]		CHK	A SHARPE	15AUG05	
TOLERANCES UNLESS OTHERWISE SPECIFIED:		APP'D	A SHARPE	15AUG05	POWER CONTACT, EUROCARD TYPE M, FEMALE 90 DEGREE, PRINTED CIRCUIT BOARD MOUNT
Ø-FIL-D ±.010 Ø-FIL-D ±.010 Ø-FIL-D ±.010 Ø-FIL-D ±.010 ANGLE: ±.010		NAME	A SHARPE	15AUG05	
MATERIAL	SEE TABLE	APPLICATION SPEC			SIZE CASE CODE DRAWING NO
FINISH		WEIGHT			A2 00779 C=5148513
		CUSTOMER DRAWING		SCALE	8:1 SHEET 1 of 1 REV C

AMP 1471-9 REV 31MM0200

14DEC05 12:07pm US040973 H:\dmmod\5148513-c.dwg

5148513

A