

**Specification Status: RELEASED**

**Maximum Operating Voltage:** 60V<sub>DC</sub>

**Fault Ratings at 20°C:**  
250 V<sub>RMS</sub>, 3A, 10 applications  
600 V<sub>RMS</sub>, 1A, 5 applications

**Additional Info at 20°C:**  
Resistance matched: 0.5 ohm  
Lightning withstand: 1.5kV per ITU-T  
Helps equipment meet ITU-T K.20/K.21 specifications

**Terminal Material:** Tin-Plated Brass

**Marking:**

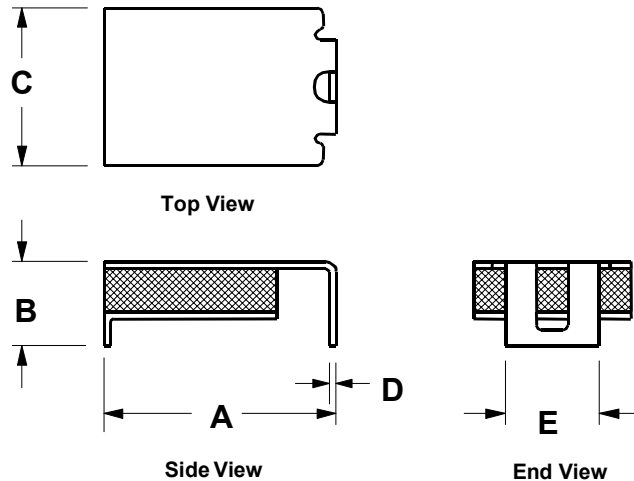
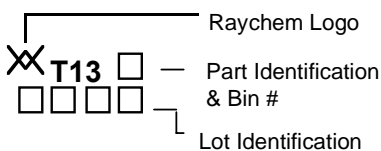

**TABLE I. DIMENSIONS:**

|     | A       |         | B   |         | C   |         | D<br>NOM | E<br>NOM |
|-----|---------|---------|-----|---------|-----|---------|----------|----------|
|     | MIN     | MAX     | MIN | MAX     | MIN | MAX     |          |          |
| mm: | 8.5     | 9.4     | --  | 3.4     | --  | 7.4     | 0.3      | 3.8      |
| in: | (0.335) | (0.370) | --  | (0.135) | --  | (0.290) | (0.011)  | (0.150)  |

\*Rounded off approximation

**TABLE II. PERFORMANCE RATINGS @ 20°C (unless otherwise noted):**

| HOLD CURRENT (A) | TRIP CURRENT (A) | RESISTANCE (Ω) |       |                      | TIME TO TRIP(Sec) @ 1A |     | OPERATING TEMPERATURE (°C) |     | TRIPPED POWER DISSIPATION (W)<br>TYP @ 60V <sub>DC</sub> |
|------------------|------------------|----------------|-------|----------------------|------------------------|-----|----------------------------|-----|--|
|                  |                  | R MIN          | R MAX | R <sub>1 MAX</sub> * | TYP                    | MAX | MIN                        | MAX |  |
| 0.130            | 0.260            | 6.5            | 12.0  | 20.0                 | 0.9                    | 2.5 | -40                        | 85  | 1.1  |

\*Maximum device resistance at 20°C measured 1 hour post trip and 24 hours post reflow

**TABLE III. APPLICABLE PART DESCRIPTIONS:**

| PART DESCRIPTION   | PCN # (INTERNAL ONLY) | PACKAGING TYPE | NOTE |
|--------------------|-----------------------|----------------|------|
| TS250-130F-B-0.5-2 | A13328-000            | Tape and Reel  | N/A  |

Agency Recognitions: UL, CSA, TUV  
UL File #E74889, CSA File #78165C

Reference Documents: Raychem PS300, ITU-T K.20/K.21

Precedence: This specification takes precedence over documents referenced herein.

Effectivity: Reference documents shall be the issue in effect on the date of invitation for bid.

Caution: Operation beyond the rated voltage or current may result in rupture, electrical arcing or flame.

**Materials Information**  
ROHS Compliant

ELV Compliant

Pb-Free

