

Specification Status: RELEASED

Maximum Operating Voltage: 60V_{DC}

Fault Ratings at 20°C:

250 V_{RMS}, 3A, 10 applications
600 V_{RMS}, 1A, 5 applications

Additional Info at 20°C:

Resistance matched: N/A
Lightning withstand: 1.5kV per ITU-T
Helps equipment meet ITU-T K.20/K.21 specifications

Terminal Material: Tin-Plated Brass

Marking:

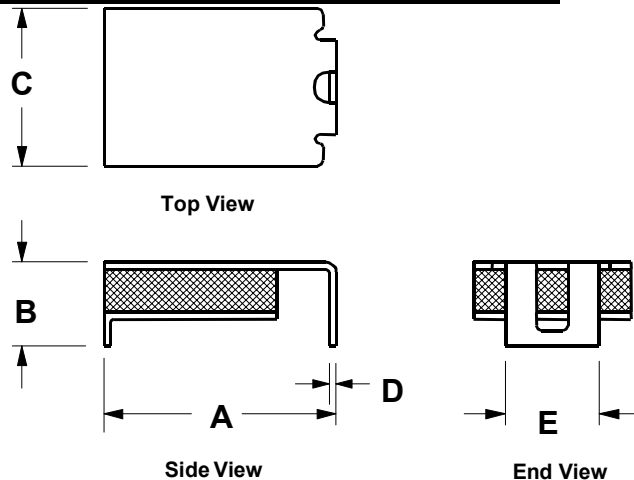
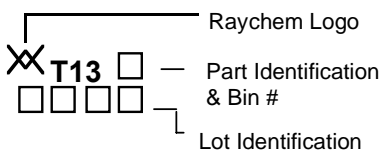

TABLE I. DIMENSIONS:

| | A | | B | | C | | D NOM | E NOM |
|-----|---------|---------|-----|---------|-----|---------|----------|----------|
| | MIN | MAX | MIN | MAX | MIN | MAX | | |
| mm: | 8.5 | 9.4 | -- | 3.4 | -- | 7.4 | 0.3 | 3.8 |
| in: | (0.335) | (0.370) | -- | (0.135) | -- | (0.290) | (0.011) | (0.150) |

*Rounded off approximation

TABLE II. PERFORMANCE RATINGS @ 20°C (unless otherwise noted):

| HOLD CURRENT (A) | TRIP CURRENT (A) | RESISTANCE (Ω) | | | TIME TO TRIP(Sec) @ 1A | | OPERATING TEMPERATURE (°C) | | TRIPPED POWER DISSIPATION (W) TYP @ 60V _{DC} |
|------------------|------------------|----------------|-------|----------------------|------------------------|-----|----------------------------|-----|--|
| | | R MIN | R MAX | R _{1 MAX} * | TYP | MAX | MIN | MAX | |
| 0.130 | 0.260 | 6.5 | 9.0 | 15.0 | 1.4 | 2.5 | -40 | 85 | 1.1 |

*Maximum device resistance at 20°C measured 1 hour post trip and 24 hours post reflow.

TABLE III. APPLICABLE PART DESCRIPTIONS:

| PART DESCRIPTION | PCN # (INTERNAL ONLY) | PACKAGING TYPE | NOTE |
|------------------|-----------------------|----------------|------|
| TS250-130F-RA-2 | E18772-000 | Tape and Reel | N/A |

Agency Recognitions: UL, CSA, TUV
UL File #E74889, CSA File #78165C

Reference Documents: Raychem PS300, ITU-T K.20/K.21

Precedence: This specification takes precedence over documents referenced herein.

Effectivity: Reference documents shall be the issue in effect on the date of invitation for bid.

Caution: Operation beyond the rated voltage or current may result in rupture, electrical arcing or flame.

Materials Information
ROHS Compliant

ELV Compliant

Pb-Free

