

Surface Mount Fuse, 7 x 2.54 mm, Quick-Acting F, 125 VAC, 125 VDC



UL 248-14 · 125 VAC · 125 VDC · Quick-Acting F



**Description**

- High Breaking Capacity
- Directly solderable on printed circuit boards

**Standards**

- UL 248-14
- CSA C22.2 no. 248.14

**Approvals**

- UL File Number: E42088
- CSA File Number: 34549

**Applications**

- Telecom
- Industrial electronic
- Household appliances

**References**

Packaging Details  
Round Solder Pads Type 172876

**Weblinks**

General Product Information, Approvals, RoHS, CHINA-RoHS, e-Store, SCHURTER-Stock-Check, Distributor-Stock-Check

**Technical Data**

Rated Voltage	63 - 125 VAC, 65 - 125 VDC
Rated Current	0.063 - 15 A
Breaking Capacity	300 A
Characteristic	Quick-Acting F
Mounting	PCB, SMT
Admissible Ambient Air Temp.	-55 °C to 85 °C
Climatic Category	55/085/56 acc. to IEC 60068-1
Material: Tube	Ceramic
Material: Endcaps	Tin-Plated Copper Alloy
Unit Weight	0.15 g
Storage Conditions	0 °C to 60 °C, max. 70% r.h.
Product Marking	Current

Soldering Methods	Reflow, Wave
Solderability	235 °C / 2 sec acc. to IEC 60068-2-58, Test Td
Resistance to Soldering Heat	260 °C / 10 sec acc. to IEC 60068-2-58, Test Td

**Dimensions**

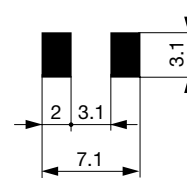
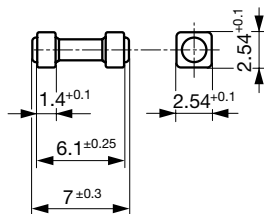
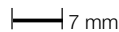

Soldering pads

**Pre-Arcing Time**

Rated Current In	1.0 x In min.	2.0 x In max.	2.75 x In max.	4.0 x In max.	10.0 x In max.
0.063 A - 0.75 A	4 h	5 s	300 ms	30 ms	5 ms
1 A - 15 A	4 h	10 s	-	60 ms	5 ms

### Variants

Rated Current [A]	Rated Voltage [VAC]	Rated Voltage [VDC]	Breaking Capacity	Voltage Drop 1.0 I <sub>n</sub> typ. [mV]	Power Dissipation 1.0 I <sub>n</sub> typ. [mW]	Melting I <sup>2</sup> t 10.0 Intyp. [A <sup>2</sup> s]		Order Number
0.063	125	125	1)	505	32	0.00022	●	7010.9900.xx
0.125	125	125	1)	590	74	0.0024	●	7010.9901.xx
0.25	125	125	1)	235	59	0.0061	●	7010.9902.xx
0.375	125	125	1)	205	77	0.012	●	7010.9903.xx
0.5	125	125	1)	190	95	0.046	●	7010.9904.xx
0.75	125	125	1)	170	128	0.09	●	7010.9905.xx
1	125	125	1)	155	155	0.11	●	7010.9906.xx
1.5	125	125	1)	160	240	0.25	●	7010.9907.xx
2	125	125	1)	150	300	0.72	●	7010.9908.xx
2.5	125	125	1)	145	363	0.91	●	7010.9909.xx
3	125	125	1)	145	435	1.3	●	7010.9910.xx
3.5	125	125	1)	140	490	1.7	●	7010.9911.xx
4	125	125	1)	135	540	2.6	●	7010.9912.xx
5	63	125	2)	125	625	4	●	7010.9913.xx
7	63	125	2)	125	875	8.5	●	7010.9914.xx
10	65	65	3)	110	1100	31	●	7010.9915.xx
12	65	65	3)	110	1320	48	●	7010.9916.xx
15	65	65	3)	100	1500	92	●	7010.9917.xx

1) 300 A @ 125 VAC , p.f. ≥ 0.95 / 300 A @ 125 VDC

2) 300 A @ 63 VAC , p.f. ≥ 0.95 / 300 A @ 125 VDC

3) 300 A @ 65 VAC , p.f. ≥ 0.95 / 300 A @ 65 VDC

### Packaging Unit

- .xx = .03 Plastic Bag (100 pcs.)
- .xx = .55 Blister Tape 18 cm Reel (500 pcs.)
- .xx = .57 Blister Tape 18 cm Reel (1500 pcs.)

### Time-Current-Curves

